

THANE *HOUSEWARES*™

THUNDER STICK™



FOOD PROCESSOR **USER'S GUIDE**

MODEL: FP9017-A
220 - 240 V

IMPORTANT SAFEGUARDS

Before using this electrical appliance, the following basic precautions should always be followed:

1. Read all instructions.
2. Before using, check that the voltage of the wall outlet corresponds with the voltage shown on the rating plate.
3. Do not operate any appliance with a damaged cord or plug or after the appliance malfunctions, or is dropped or damaged in any manner. Return appliance to the nearest qualified service facility for examination, repair or electrical or mechanical adjustment.
4. If the supply cord is damaged it must be replaced by the manufacturer or a qualified service agent or technician in order to avoid a hazard.
5. Unplug from outlet when not in use, before putting on or taking off parts, and before cleaning.
6. Do not let the cord hang over the edge of a counter or hot surface.
7. To avoid the risk of electric shock, do not try to disassemble the THUNDERSTICK™ appliance. Take it to a qualified service facility for repair. Incorrect reassembly can cause a risk of electric shock when the THUNDERSTICK™ appliance is used, and will void the warranty.
8. Never disconnect the appliance from the electrical outlet by pulling on the cord. Always grasp the plug and pull to disconnect.
9. To avoid the risk of electric shock, do not immerse motor appliance of blender in water or other liquids. If the appliance falls into liquid, remove immediately, but do not reach into the liquid unless the appliance is unplugged.
10. Close supervision is necessary when this appliance is being used near children or infirm persons.

4. Mixing cup, food processor bowl, small and large food pusher, blender jug (optional item) and chopper bowl (optional item):

Wash these parts in soapy water, rinse and dry thoroughly. Although these parts are dishwasher safe we recommend to clean them manually since the plastic material may deteriorate if frequently machine washed.

5. The non-slip base on the bottom of the mixing cup, bowl and jug can be detached for cleaning, Wash it in soapy water, rinse and dry thoroughly. Make sure it is in place before next use.

DO NOT PUT IN DISHWASHER.

6. Food processor lid, blender jug lid (optional item) and chopper bowl lid (optional item):

Wipe the lid with a damp cloth or sponge and dry thoroughly.

After cleaning the lid, place it on a flat and dry surface so that any remaining water can drain out.

DO NOT PUT IN DISHWASHER.

NOTE: Do not immerse the lid in water as the lubrication on the bearings may wash away.

7. Storage Lids:

Wash the storage lids in soapy water, rinse and let it dry.

DO NOT PUT IN DISHWASHER.

DISPOSAL:

Please check the regulations in your area before discarding this appliance. Electrical equipment may be subject to special rules regarding disposal.



CLEANING AND MAINTENANCE

CAUTION Always be sure that the motor appliance is unplugged and removed from any attachment before cleaning.

1. Motor appliance: Wipe the motor appliance with a damp cloth and dry thoroughly.

CAUTION Do not wash the motor appliance under running water, or immerse it into any liquid. Fig. 1a.

DO NOT PUT IN DISHWASHER.

2. Detachable shaft: Wash the detachable shaft under running water without the use of abrasive cleaners or detergents. Fig. 2a.

DO NOT PUT IN DISHWASHER.

NOTE: Do not immerse the detachable stem in water as the lubrication on the bearings may wash away. After cleaning the detachable shaft place it upright so that any remaining water can drain out.

3. Blades and Disc Blade: Wash the blades and Disc Blade in soapy water, rinse and let it dry. Fig. 3a

DO NOT PUT IN DISHWASHER.

NOTE: Some food may discolor the Disc Blade. This is normal and will not harm the plastic or affect the flavor of food. Rub with cloth dipped within vegetable oil to remove discoloration.

CAUTION Blades and discs are very sharp, handle with care.

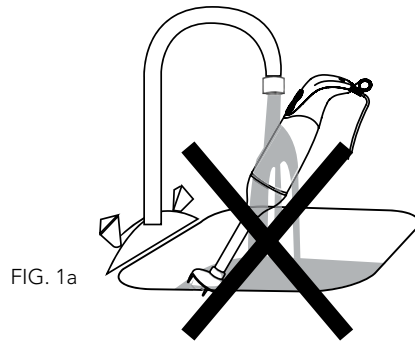

FIG. 1a

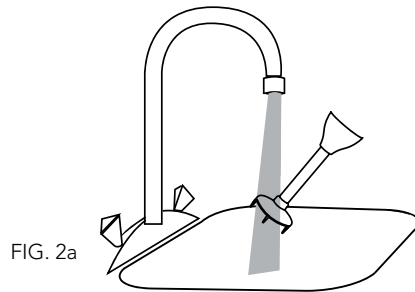

FIG. 2a

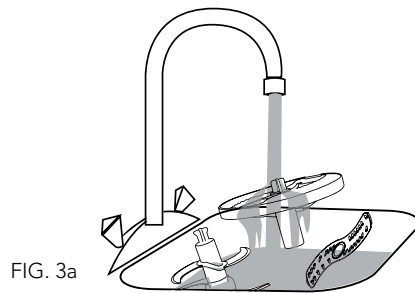

FIG. 3a

IMPORTANT SAFEGUARDS - continued

11. This appliance is not intended for use by children or persons with reduced physical, sensory or mental capabilities, or lack of experience and knowledge, unless they have been given supervision or instruction concerning the use of the appliance by a person responsible for their safety.
12. Children should be supervised to ensure that they do not play with the appliance.
13. Avoid contact with moving parts.
14. Keep hands and utensils out of the container while operating the appliance to reduce the risk of severe injury to persons or damage to the blades. A scraper may be used but only when the appliance is not running.
15. The appliance cannot be used for processing hard substances, otherwise the blade could be blunted.
16. Be sure the bowl lid is securely locked in place before operating the appliance.
17. The use of an accessory not recommended or sold by the manufacturer may cause electric shock or injuries to persons.
18. Do not operate the appliance for anything other than its intended use.
19. Never insert food by hand. Always use food pusher.
20. Before removing the motor appliance from the bowl, switch off the appliance, wait until the blades have come to a complete stop and then remove the motor appliance.
21. Do not use fingers to scrape food away from the blade while the appliance is operating. This may result in injury.

IMPORTANT SAFEGUARDS - continued

22. Always remove the blade assembly before pouring contents from the bowl.
23. Be sure to switch off the appliance after each use of your food processor. Make sure the motor stops completely before disassembling.
24. Do not put your fingers or other objects into the appliance opening while it is in operation. If food becomes lodged in the opening, use the food pusher or another piece of fruit or vegetable to push it down. When this method is not possible, turn the motor off and disassemble to remove the remaining food.
25. The metal blades are extremely sharp, handle with care. Always hold the blade assembly by the finger grip or stem, away from the cutting edge, both when handling and cleaning.
26. To reduce the risk of injury, never place cutting blade or discs on base without first putting the bowl properly in place.
27. When mixing liquids, especially hot liquids, use a tall container or make small quantities at a time to reduce spillage.
28. Do not use outdoors.

SAVE THESE INSTRUCTIONS

HOUSEHOLD USE ONLY

9. Remove the chopper blade from the chopper bowl as shown in Fig. 9a, and pour out the chopped food.
10. If you want to store the chopped food in the chopper bowl, use the storage lid as illustrated in Fig. 10a and refrigerate. Do not store the chopped food in the bowl for an extended period.

CAUTION Keep the electrical cord away from any hot surface.

CAUTION Always unplug the THUNDERSTICK™ after use.

CAUTION Keep THUNDERSTICK™ out of reach of children.

CAUTION Blades are very sharp, keep fingers away.



FIG. 9a

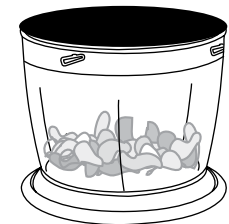

FIG. 10a

6. During processing, you can adjust the speed by selecting the LOW (I) or HIGH (II) speed button.
7. To stop the THUNDERSTICK™ take your fingers off the switch button (I) or (II). Unplug the appliance from the power outlet.
8. Turn the motor appliance counter-clockwise until the arrow mark on the motor appliance is aligned with the unlocked symbol (⤵) on the chopper lid, as illustrated in Fig. 8a. Detach the motor appliance from the lid as illustrated in Fig. 8b. Turn the lid in a counter-clockwise direction as illustrated in Fig. 8c to remove from the chopper bowl as shown in Fig. 8d.

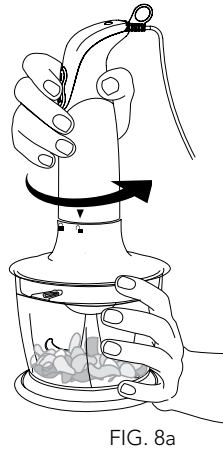

FIG. 8a

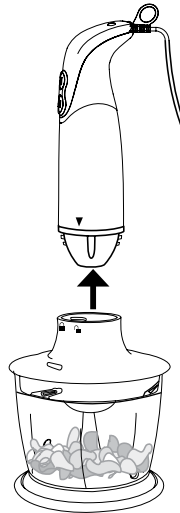

FIG. 8b



FIG. 8c

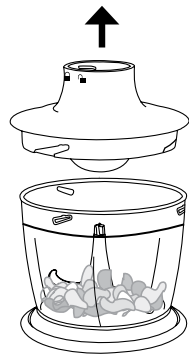

FIG. 8d

CAUTION Do not open the lid until the blades stop rotating.

BEFORE THE FIRST USE

Check that all accessories are complete and not damaged, and wash all detachable parts thoroughly according to the section CLEANING AND MAINTENANCE.

CAUTION Blades and discs are very sharp, handle with care.

CAUTION Do not rinse the motor appliance or submerge it in water.



MOTOR APPLIANCE (POWER WAND)

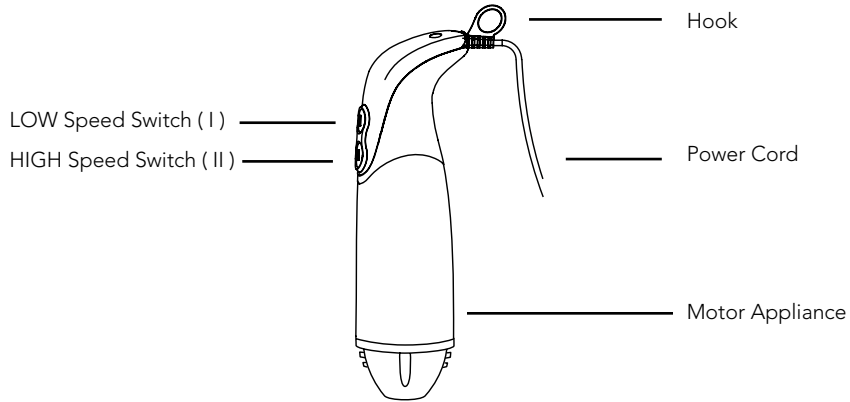

ATTACHMENTS

HAND BLENDER (VORTEX BLENDER)

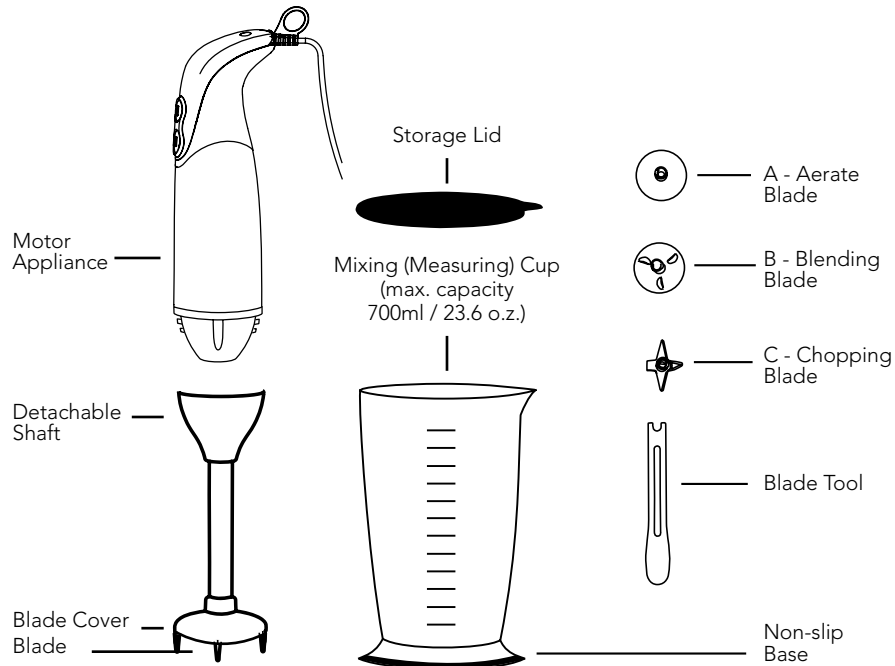

HOW TO OPERATE THE CHOPPER

Use the chopper to chop small amounts of food such as meat, cheese, onions, herbs, garlic, carrots, nuts, etc.

NOTE: Do not use the blender for processing hard cheese

1. Place the chopper on a flat surface such as the kitchen countertop.
2. Place the food into the chopper bowl.
3. Make sure that the chopper lid is securely locked in place.

NOTE: Before processing fruit remove any pits, if chopping meat, remove the bone, cut into small pieces, then place the meat into the chopper bowl, the maximum quantity of meat in the chopper bowl cannot exceed 120g (7oz).

4. Plug the THUNDERSTICK™ into a power outlet.
5. Hold the motor body with one hand and the chopper bowl with the other and then select the required speed and press the (I) switch for LOW speed or (II) switch for HIGH speed, refer to Fig. 5a.

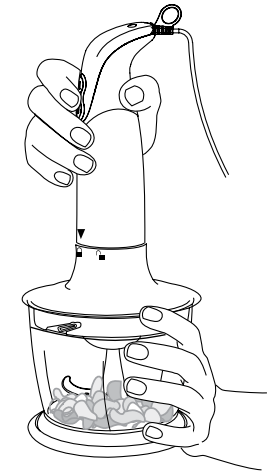
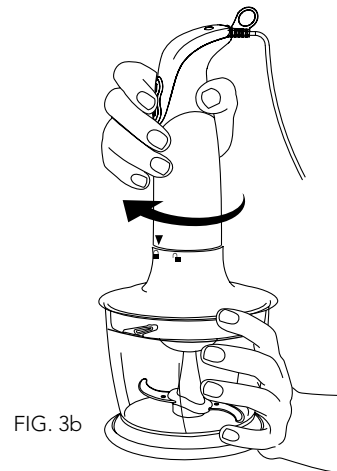
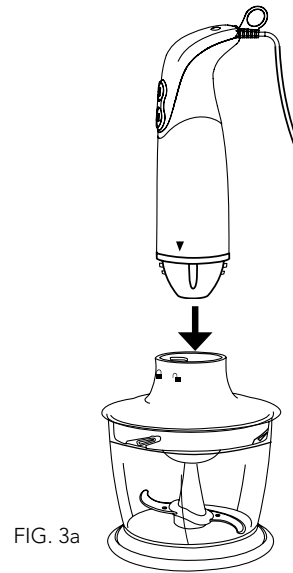

FIG. 5a

NOTICE Maximum time of continuous use at high or low speed should not exceed 20 seconds.

NOTICE The appliance cannot be used for processing hard food as it will damage the blades.

3. To assemble the motor appliance, align the arrow mark on the motor appliance with the unlocked symbol (🔓) on the chopper lid and attach the motor body to the chopper lid, as shown in Fig. 3a. Turn the motor body in a clockwise direction until the arrow mark on the motor appliance is aligned with the locked symbol (🔒) on the lid and the motor appliance is securely locked in place, as shown in Fig. 3b.



ASSEMBLY OF THE HAND BLENDER

⚠ CAUTION

Always be sure that the appliance is unplugged before attaching or removing any attachments.

⚠ CAUTION

The blades are very sharp. Handle with care.

⚠ CAUTION

Always place the mixing cup on a clean level surface and check if the non-slip base on the bottom of the mixing cup is in place before use.

1. SELECT YOUR BLADE

A - Aerate blade:



The Aerating Blade is best suited for whipping and mixing ingredients. Move in an up and down motion to draw the air in. Whips creams, sauces, milk, frostings and egg whites; Mixes omelets and cake mixtures.

B - Blending blade:



The Blending Blade is best suited for whisking and blending liquids. Move in a circular and up and down motion to mix thoroughly. Whisks mayonnaise and creams; Blends all liquids.

C - Chopping blade:



The Chopping Blade is best suited for chopping, pureeing, blending and mixing. Move in a circular motion to evenly chop or combine the ingredients, move in an up and down and circular motion for pureeing and blending ingredients. Chops vegetables, fruit and berries; minces cooked meat; purees potatoes and other vegetables; blends liquids; mixes omelets and cake mixtures; chops and blends smoothies.

2. HOW TO INSTALL THE BLADE

Align the indentation on the blade with the stop pin on the spindle rod and carefully attach the blade onto the spindle pin as illustrated in Fig. 2a.

Push the blade all the way down until it is locked with the stop pin as illustrated in Fig. 2b.

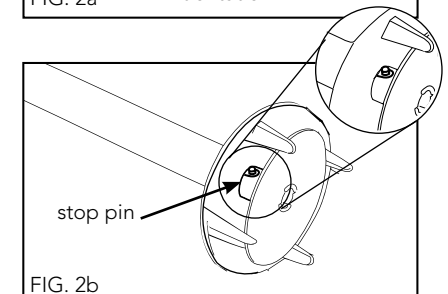
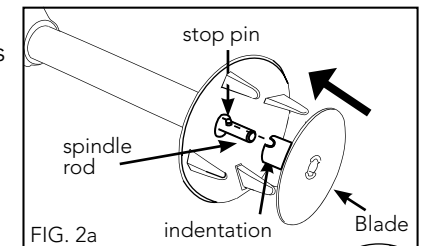

3. HOW TO REMOVE THE BLADE

Insert the blade tool under the blade as illustrated in Fig. 3a.

NOTE: The blade tool must be positioned under the blade on the opposite side of the stop pin as illustrated in Fig. 3b, so the stop pin is not in the way and doesn't obstruct movement of the blade tool.

Remove the blade by pushing it out with the blade tool. When removing the blade always point the bottom part of the detachable shaft against the countertop surface in such a way that when the blade is pushed out it safely lands on the countertop Fig. 3c.

CAUTION Exercise caution when removing the blade.

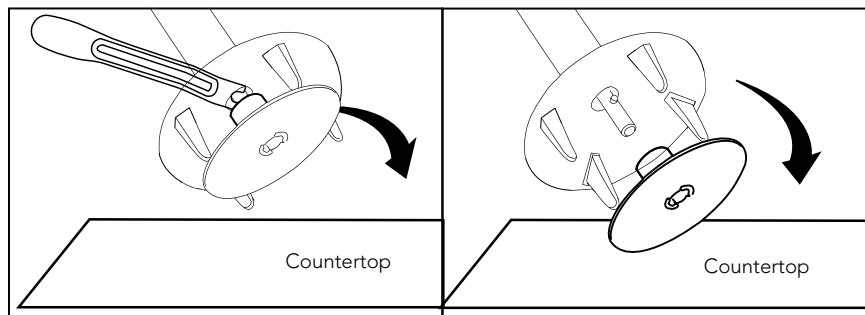

FIG. 3c.

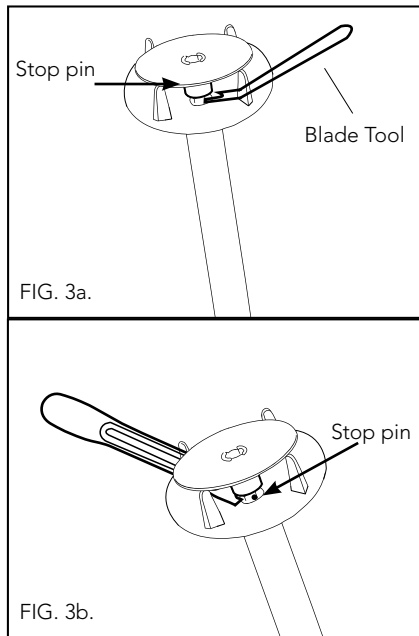

FIG. 3a.

FIG. 3b.

ASSEMBLY OF THE CHOPPER

CAUTION

Always be sure that the appliance is unplugged before attaching or removing any attachments.

CAUTION

The blades are very sharp. Handle with care.

CAUTION

Always place the chopper bowl on a clean level surface and check if the non-slip base on the bottom of the chopper bowl is in place before assembly.

1. Assemble the chopper blade by placing the blade over the pin in the chopper bowl as shown in Fig. 1a.
 2. Attach the Chopper lid onto the bowl, refer to Fig. 2a., and turn it in a clockwise direction until the tongs on the chopper bowl are aligned and locked with the grooves on the chopper lid, as illustrated in Fig 2b.
- To detach the lid, turn it in the opposite direction.

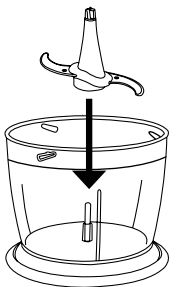

FIG. 1a

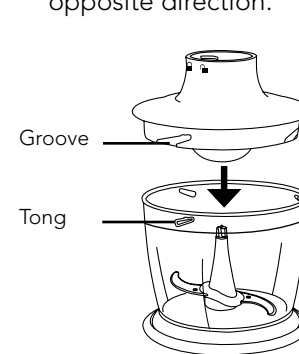

FIG. 2a

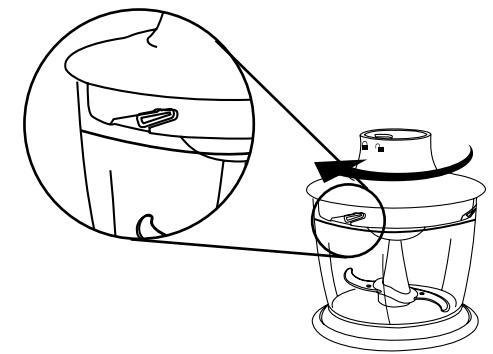
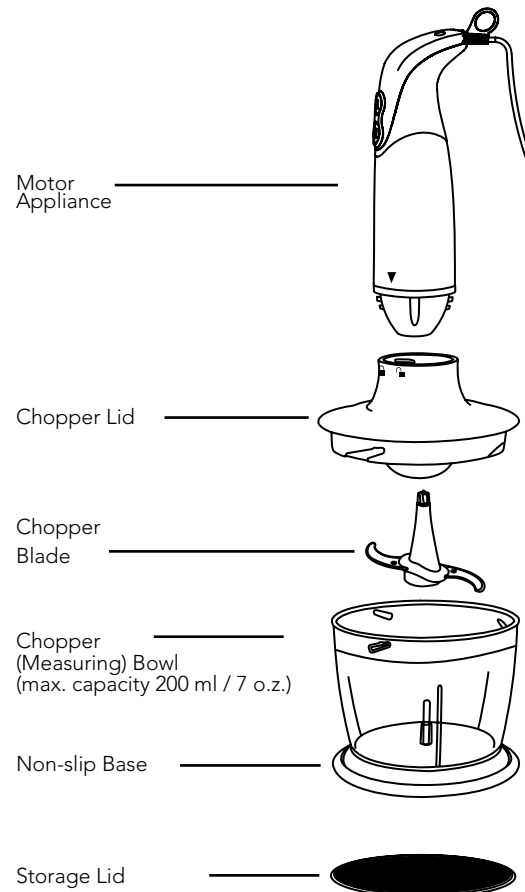

FIG. 2b

CHOPPER



4. SHAFT ASSEMBLY

To assemble the detachable shaft with the motor appliance, align the arrow mark on the motor appliance with the unlocked symbol (🔓) on the detachable shaft and attach the shaft to the motor body. Turn the motor body in the clockwise direction until the arrow mark on the motor appliance is aligned with the locked symbol (🔒) on the detachable shaft and the motor appliance is locked in place as shown in Fig. 4a.

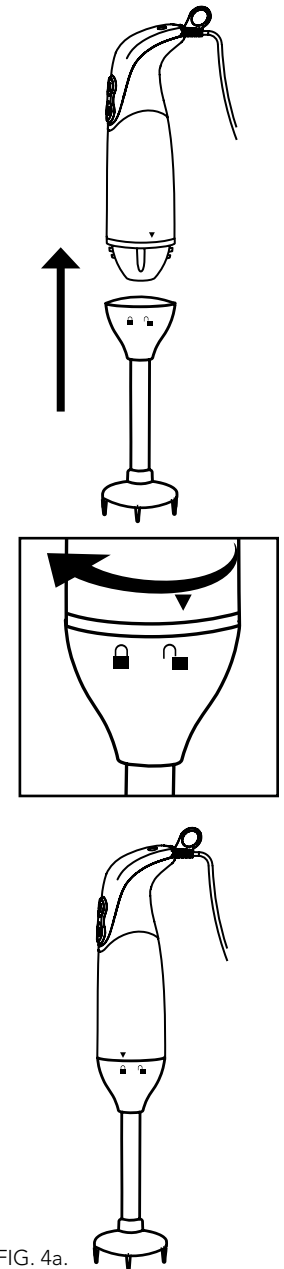

FIG. 4a.

HOW TO OPERATE THE HAND BLENDER

1. Place food in the mixing cup.

For the most consistent results, do not overfill the mixing container and process the food in smaller quantities.

NOTE: Before processing fruit remove any pits.

NOTE: The maximum quantity of food can't exceed the maximum capacity of the mixing cup for each operation.

2. Plug the THUNDERSTICK™ into a power outlet.

3. Hold the motor body with one hand and the mixing cup with the other, and then lower the blade into the food.

Select the required speed and press the (I) switch for LOW or (II) switch for HIGH speed.

Guide the blender through the food, slowly moving up and down and from side to side. Fig. 3a.

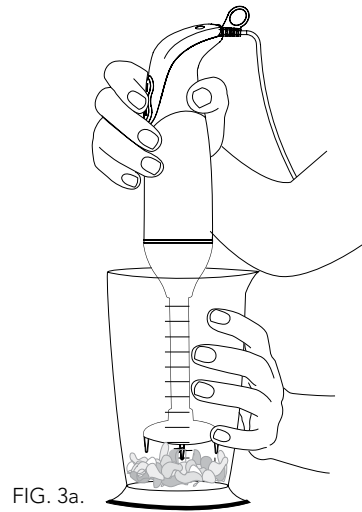

NOTICE Maximum time of continuous use at high or low speed should not exceed 30 seconds.

CAUTION Exercise caution when blending hot liquids/food - Danger of scalding by splashing hot liquids/food. To avoid splashing: place the blade in the food before switching on; wait for blade to stop rotating before taking the blade out of the food; do not overfill the mixing container.

10. Remove the vortex 4 blade for blender from the blender jug as illustrated in Fig. 10a, and pour out the blended food.

11. If you want to store the blended food in the blender jug use the storage lid and refrigerate as illustrated in Fig. 11a. Do not store the blended food in the jug for an extended period.

CAUTION Keep the electrical cord away from any hot surface.

CAUTION Always unplug the THUNDERSTICK™ after use.

CAUTION Keep the THUNDERSTICK™ out of reach of children.

CAUTION Blades are very sharp; keep fingers away.

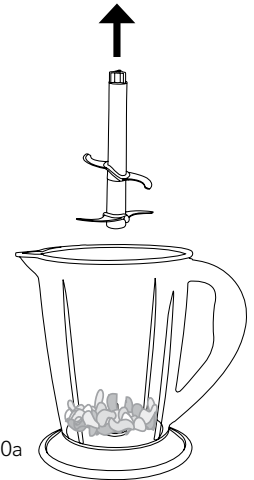

FIG. 10a

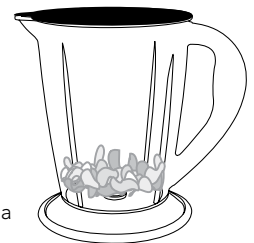
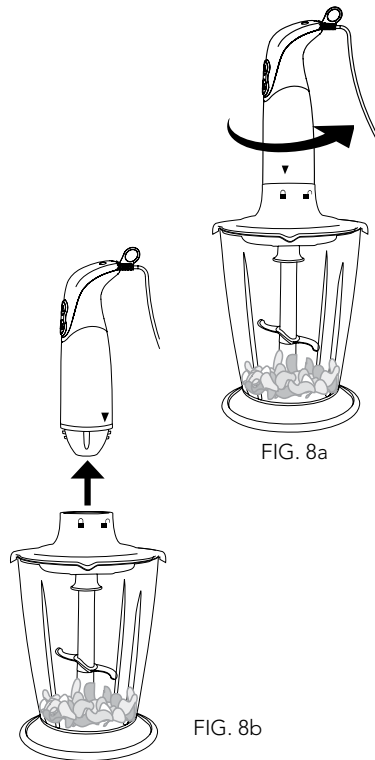

FIG. 11a

- To stop the THUNDERSTICK™ take your fingers off the switch button (I) or (II). Unplug the appliance from the power outlet.
- Turn the motor appliance counter-clockwise until the arrow mark on the motor appliance is aligned with the unlocked symbol (☞) on the blender lid. Detach the motor appliance from the lid as illustrated in Fig. 8a and 8b.

CAUTION Do not open the lid until the blades stop rotating.



- Remove the lid by pulling out the locking clips on either side of the lid as illustrated in Fig. 9a and 9b.

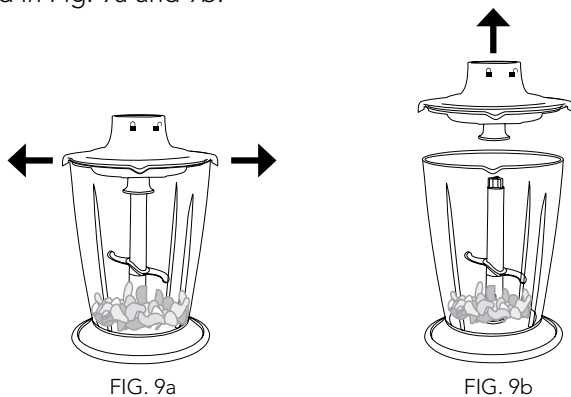

CAUTION Do not immerse the hand blender into any liquid or food mixture above the seam where the shaft attaches to the motor appliance.

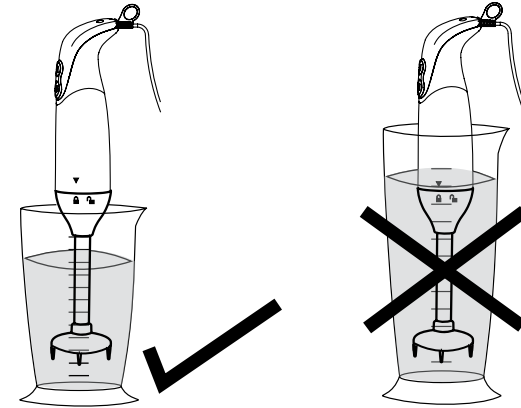

- During processing you can adjust the speed by selecting the LOW (I) or HIGH (II) speed button.

NOTICE The hand blender (A,B,C blades) cannot be used for blending hard food and ice as it will damage the blades.

NOTICE When blending vegetables or fruit, usually a certain amount of water has to be added to facilitate the smooth running of the appliance.

NOTICE When pureeing food, it is important to use enough liquid (juice, milk or cream, broth, etc.) to have a smooth mixture. Adjust the consistency of the mixture by adding more liquids or soft solids.

- To stop the THUNDERSTICK™ take your fingers off the switch button (I) or (II).

Wait for the blade to stop rotating and lift the Hand Blender from the mixture. Unplug the appliance.

CAUTION Keep electrical cord away from any hot surface.

CAUTION Always unplug the THUNDERSTICK™ after use.

CAUTION Keep the THUNDERSTICK™ out of reach of children.

CAUTION Blades are very sharp; keep fingers away.

- For refrigerating and storage, use the Storage Lid as illustrated in Fig. 6a.

Do not store processed food in the mixer cup for extended periods.

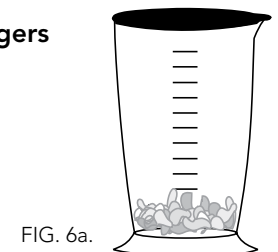
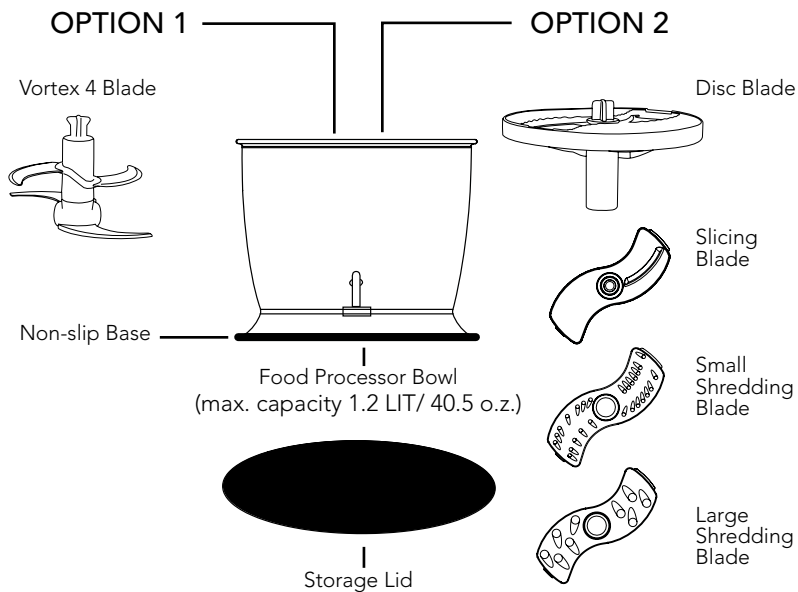
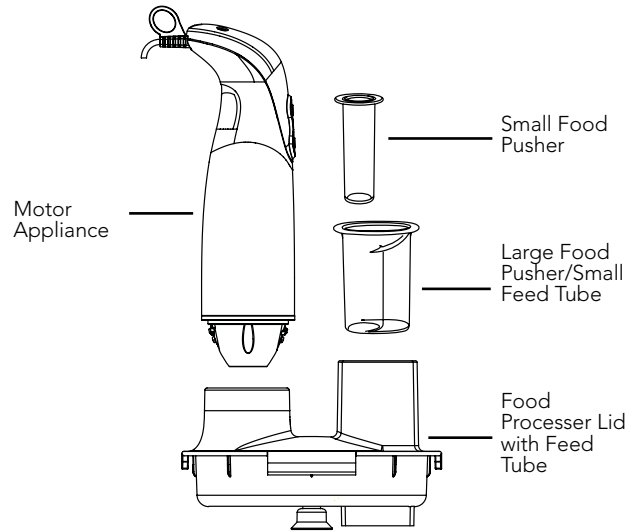

FIG. 6a.

FOOD PROCESSOR



HOW TO OPERATE THE BLENDER

Use the blender for blending juices, smoothies, and vegetables. The blender can also be used for processing meat.

NOTE: Do not use the blender for processing hard cheese.

1. Make sure that the non-slip base is correctly attached to the bottom of the blender jug.
2. Place the blender on a flat surface such as a kitchen countertop.
3. Place the ingredients inside the blender jug.

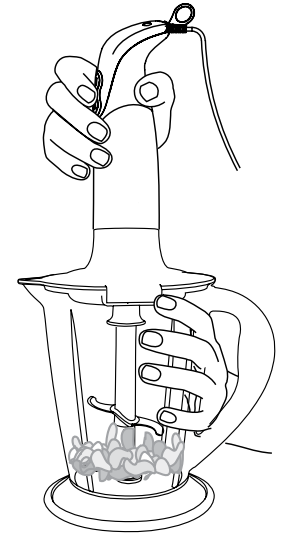

NOTE: Before blending fruit remove any pits, and if processing meat remove any bones and cut into small pieces.

For the most consistent results do not overfill the jug, and blend the food in smaller quantities.

4. Make sure that the blender lid is securely locked in place.
5. Plug the THUNDERSTICK™ into a power outlet.
6. Hold the motor body with one hand and the blender jug with the other and then select the required speed and press the (I) switch for LOW or (II) switch for HIGH speed.

NOTICE Maximum time of continuous use at high or low speed should not exceed 30 seconds, when processing vegetables or 20 seconds when processing meat.

NOTICE The appliance cannot be used for processing hard food as it will damage the blades.

3. To assemble the motor appliance, align the arrow mark on the motor appliance with the unlocked symbol (⌚) on the blender lid and attach the motor body to the blender lid. Turn the motor body in the clockwise direction until the arrow mark on the motor appliance is aligned with the locked symbol (🔒) on the lid and the motor appliance is securely locked in place as shown in Fig. 3a.

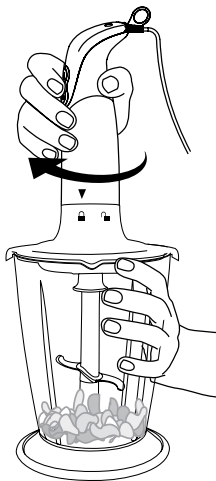
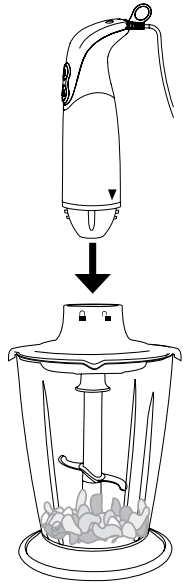

FIG. 3a.

ASSEMBLY OF OPTION 1 - VORTEX 4 BLADE

⚠ CAUTION

Always be sure that the appliance is unplugged before attaching or removing any attachments.

⚠ CAUTION

The blades are very sharp. Handle with care.

⚠ CAUTION

Always place the food processor bowl on a clean level surface and check if the non-slip base on the bottom of the food processor bowl is in place before assembly.

1. Assemble the vortex 4 blade over the pin in the food processor bowl as shown in Fig. 1a.

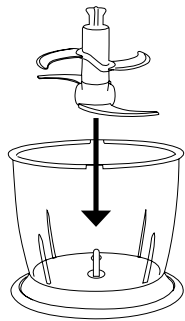

FIG. 1a.

2. Attach the food processor lid onto the bowl, refer to Fig. 2a. Make sure that the two tongs (extensions) on the lid are aligned with the two grooves on the food processor bowl as illustrated in Fig. 2b. Once the two tongs on the lid are slotted in the two grooves, push down the lid until it is securely locked in place as illustrated in Fig. 2c.

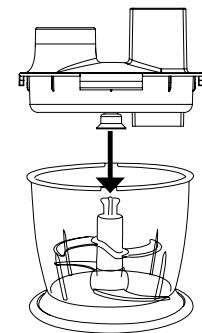

FIG. 2a.

NOTE: Make sure that the food processor lid is securely locked in place before operating the appliance.

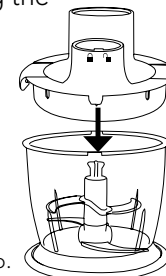

FIG. 2b.

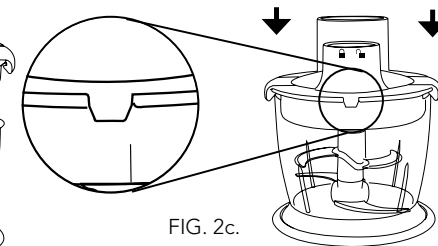

FIG. 2c.

3. To assemble the motor appliance, align the arrow mark on the motor appliance with the unlocked symbol (🔓) on the food processor lid and attach the motor body to the food processor lid. Turn the motor body in the clockwise direction until the arrow mark on the motor appliance is aligned with the locked symbol (🔒) on the lid and the motor appliance is securely locked in place as shown in Fig. 3a.

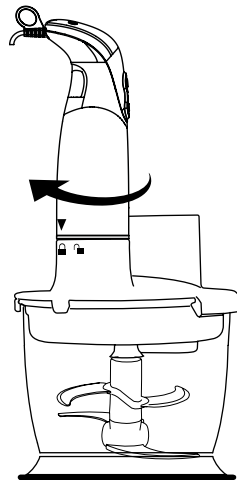
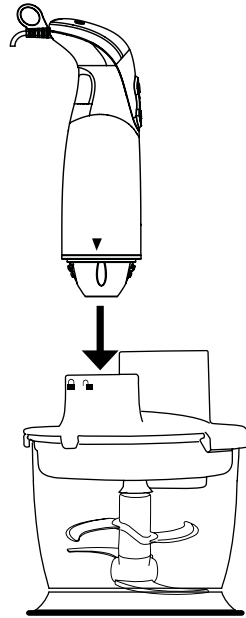

FIG. 3a.

ASSEMBLY OF THE BLENDER

CAUTION

Always be sure that the appliance is unplugged before attaching or removing any attachments.

CAUTION

The blades are very sharp. Handle with care.

CAUTION

Always place the blender jug on a clean level surface and check if the non-slip base on the bottom of the blender jug is in place before assembly.

1. Assemble the vortex 4 blade for blender over the pin in the blender jug as shown in Fig.1a.

NOTE: Never add food before installing the vortex 4 blade for blender.

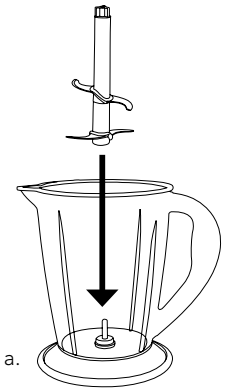

FIG. 1a.

2. Attach the blender lid onto the blender jug, make sure that the spout cover on the lid is aligned with the spout on the blender jug. Push down the lid until it is securely locked in place as illustrated in Fig. 2a and 2b.

NOTE: Make sure that the blender lid is securely locked in place before operating the appliance.

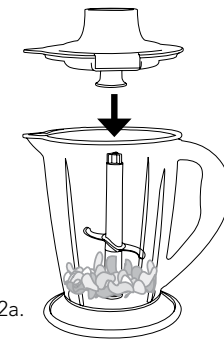

FIG. 2a.

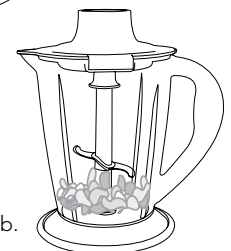
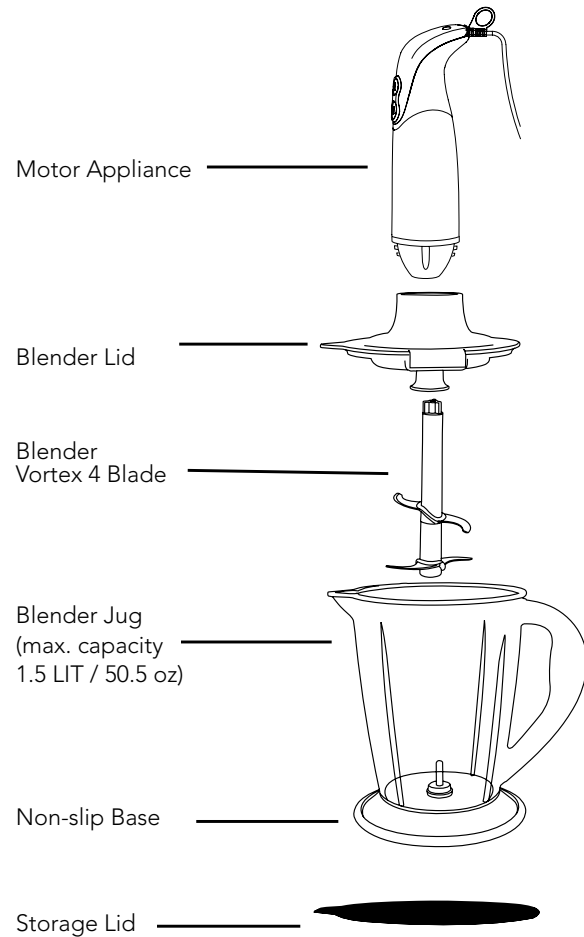

FIG. 2b.

OPTIONAL ATTACHMENTS

BLENDER



HOW TO OPERATE THE FOOD PROCESSOR WITH VORTEX 4 BLADE

Use the chopper to chop small amounts of food such as meat, cheese, onions, herbs, garlic, carrots, nuts, etc.

1. Make sure that the non-slip base is correctly attached to the bottom of the food processor bowl.
2. Place the food processor on a flat surface such as a kitchen countertop.
3. Place the food inside the food processor bowl or insert the food through the feed tube on the lid once the lid is installed.

NOTE: Before processing fruit remove any pits, and if processing meat remove any bones and cut into small pieces.

NOTE: Do not use for processing hard cheese.

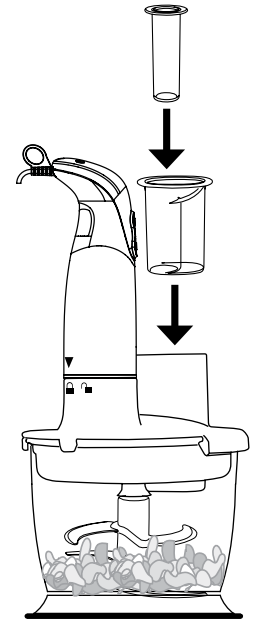

For the most consistent results do not overfill the bowl and process the food in smaller quantities.

4. Make sure that the lid is securely locked and the large food pusher and the small food pusher are in place.
5. Plug the THUNDERSTICK™ into a power outlet.
6. Hold the motor body with one hand and the food processor bowl with the other and then select the required speed and press the (I) switch for LOW or (II) switch for HIGH speed.

NOTICE Maximum time of continuous use at high or low speed should not exceed 30 seconds.

7. During processing you can adjust the speed by selecting the LOW (I) or HIGH (II) speed button.

NOTE: During operation, you can insert the food through the feed tube and use the food pusher to push the food through if necessary.

CAUTION Never use your fingers to push the food through the feed tube.

NOTICE The appliance cannot be used for processing hard food as it will damage the blades.

- To stop the THUNDERSTICK™ take your fingers off the switch button (I) or (II). Unplug the appliance from the power outlet.
- Turn the motor appliance counter-clockwise until the arrow mark on the motor appliance is aligned with the unlocked symbol (⌚) on the food processor lid as illustrated in Fig. 9a. Detach the motor appliance from the lid as illustrated in Fig. 9b.

CAUTION Do not open the lid until the blades stop rotating.

- Remove the lid by pulling out the locking clips on either side of the lid as illustrated in Fig. 10a and 10b.

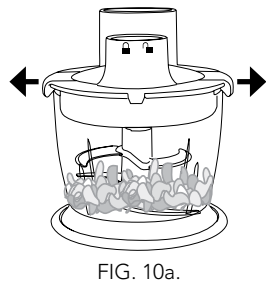

FIG. 10a.

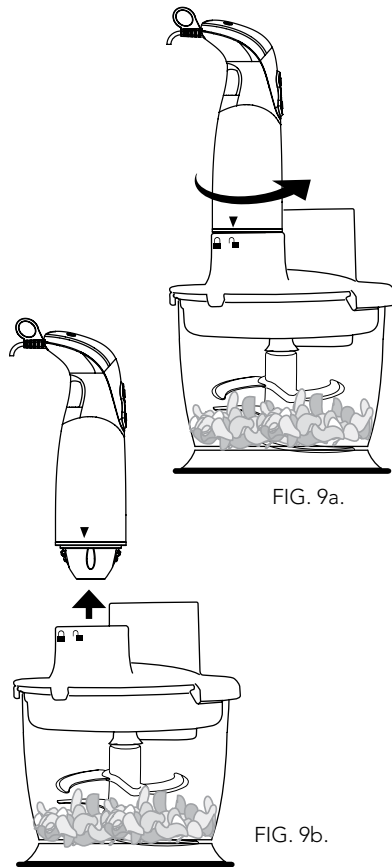

FIG. 9a.

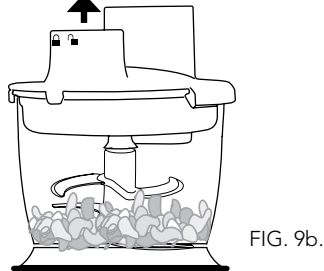

FIG. 9b.

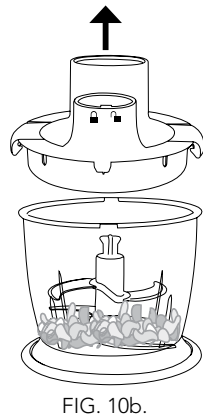

FIG. 10b.

TIPS:

- Use fresh ingredients.
- Do not cut small pieces of food. Cut food to fit feed tube and insert food into tube securely to keep food from slipping sideways during processing.
- Food placed upright comes out shorter than food placed horizontally.
- There will always be a small amount of waste left on the disc or in the bowl after processing.

HOW TO CHANGE / REMOVE THE BLADE FROM THE DISC

- Hold the disc with one hand and with the other hand push the long locking clip inwards until the blade pops up as illustrated in Fig. 1a and 1b.
- Remove the blade from the disc as illustrated in Fig. 2a.

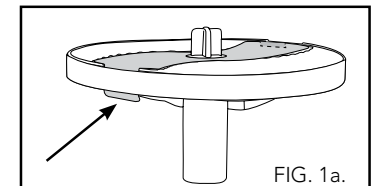

FIG. 1a.

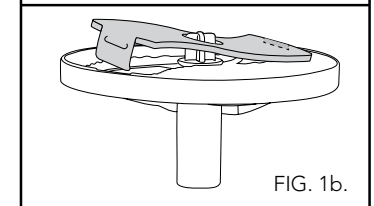

FIG. 1b.

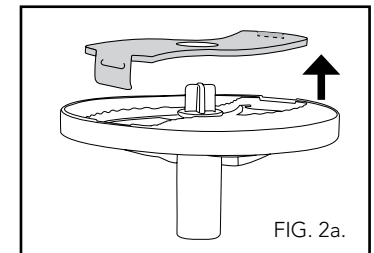

FIG. 2a.

10. Remove the lid by pulling out the locking clips on either side of the lid as illustrated in Fig. 10a. and 10b.

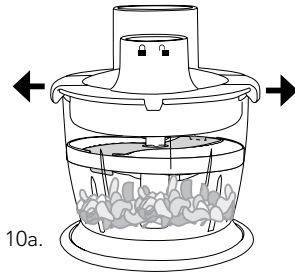

FIG. 10a.

11. Remove the Disc Blade from the food processor bowl as illustrated in Fig. 11a and pour out the processed food.

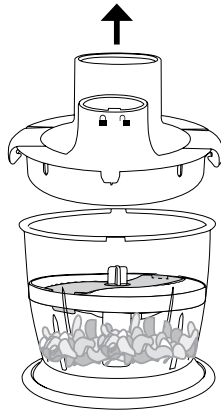

FIG. 10b.

12. If you want to store the processed food in the food processor bowl use the storage lid as illustrated in Fig. 12a and refrigerate. Do not store the processed food in the bowl for an extended period.

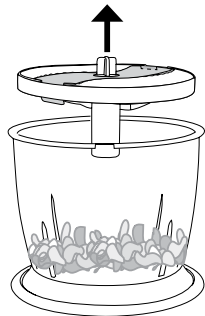

FIG. 11a.

CAUTION Keep the electrical cord away from any hot surface.

CAUTION Always unplug the THUNDERSTICK™ after use.

CAUTION Keep the THUNDERSTICK™ out of reach of children.

CAUTION Blades are very sharp; keep fingers away.

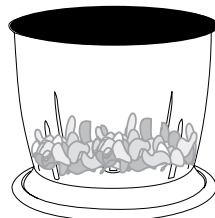

FIG. 12a.

11. Remove the vortex 4 blade from the food processor bowl as illustrated in Fig. 11a and pour out the processed food.

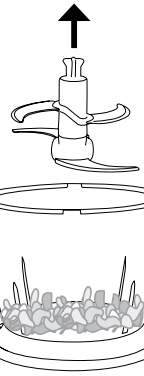

FIG. 11a.

12. If you want to store the processed food in the food processor bowl use the storage lid as illustrated in Fig. 12a and refrigerate. Do not store the processed food in the bowl for an extended period.

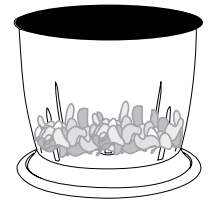

FIG. 12a.

CAUTION Keep the electrical cord away from any hot surface.

CAUTION Always unplug the THUNDERSTICK™ after use.

CAUTION Keep the THUNDERSTICK™ out of reach of children.

CAUTION Blades are very sharp; keep fingers away.

ASSEMBLY OF OPTION 2 - DISC BLADE

⚠ CAUTION

Always be sure that the appliance is unplugged before attaching or removing any attachments.

⚠ CAUTION

The blades are very sharp. Handle with care.

⚠ CAUTION

Always place the food processor bowl on a clean level surface and check if the non-slip base on the bottom of the food processor bowl is in place before assembly.

1. Select the Blade

SLICING BLADE

The Slicing Blade is best suited for slicing carrots, potatoes, cucumbers, cabbage, and foods of similar texture. This blade is great for making baked potato chips and sliced vegetables.

SMALL

SHREDDING BLADE

The Small Shredding Blade is best suited for shredding food items such as cheese, apples, cabbage, carrots, and cucumbers into small pieces for salads and toppings.

LARGE

SHREDDING BLADE

The Large Shredding Blade is best suited for shredding food items into larger pieces.

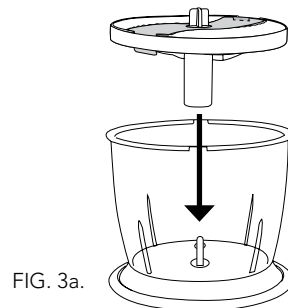
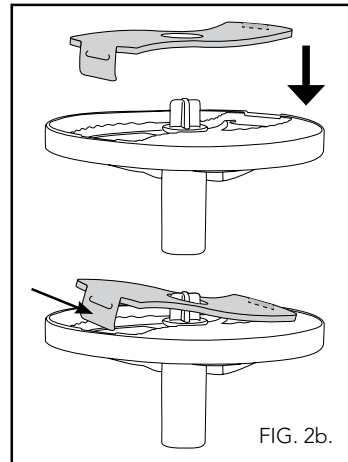
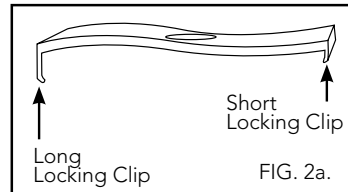
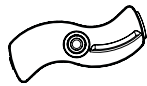

2. Locate the short and long locking clip on the blade as illustrated in Fig. 2a.

First insert the short locking clip into the designated slot on the disc and then push the other side of the disc with the long locking clip until it is firmly locked in place as illustrated in Fig. 2b.

9. Turn the motor appliance counter-clockwise until the arrow mark on the motor appliance is aligned with the unlocked symbol (🔓) on the food processor lid as illustrated in Fig. 9a. Detach the motor appliance from the lid as illustrated in Fig. 9b.

⚠ CAUTION

Do not open the lid until the blades stop rotating.

FIG. 9a.

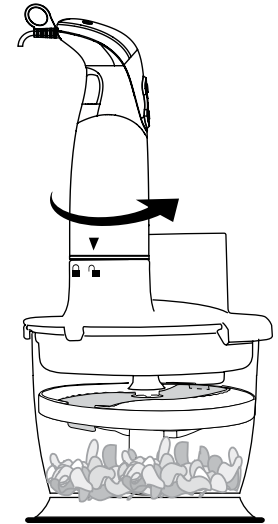
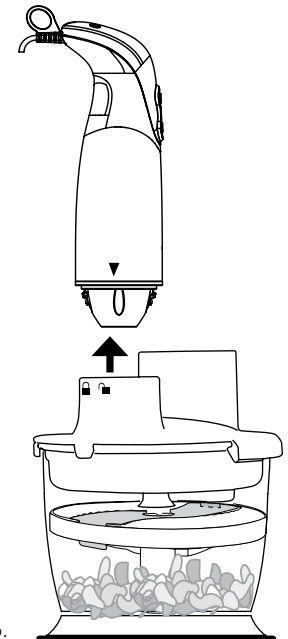

FIG. 9b.



6. Hold the motor body with one hand, select the required speed and press the (I) switch for LOW or (II) switch for HIGH speed. Using the other hand insert the food through the feed tube and use the food pusher to push the food through if necessary.

CAUTION Never use your fingers to push the food through the feed tube.

7. During processing you can adjust the speed by selecting the LOW (I) or HIGH (II) speed button.

NOTE: The maximum quantity of food can't exceed the maximum capacity of the bowl for each operation.

For the most consistent results do not overfill the bowl and process the food in smaller quantities.

NOTICE The appliance cannot be used for processing hard food as it will damage the blades.

8. To stop the THUNDERSTICK™ take your fingers off the switch button (I) or (II) and unplug the appliance from the power outlet.

3. Assemble the Disc Blade (with desired blade) over the pin in the food processor bowl as illustrated in Fig. 3a.

NOTE: Never add food before installing the Disc Blade.

4. Attach the food processor lid onto the bowl, refer to Fig. 4a. Make sure that the two tongs (extensions) on the lid are aligned with the two grooves on the food processor bowl as illustrated in Fig. 4b.

Once the two tongs on the lid are slotted in the two grooves, push down the lid until it is securely locked in place as illustrated in Fig. 4c.

NOTE: Make sure that the food processor lid is securely locked in place before operating the appliance.

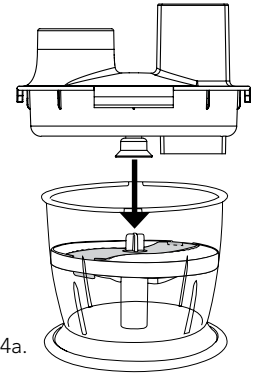

FIG. 4a.

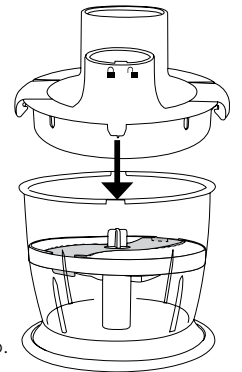

FIG. 4b.

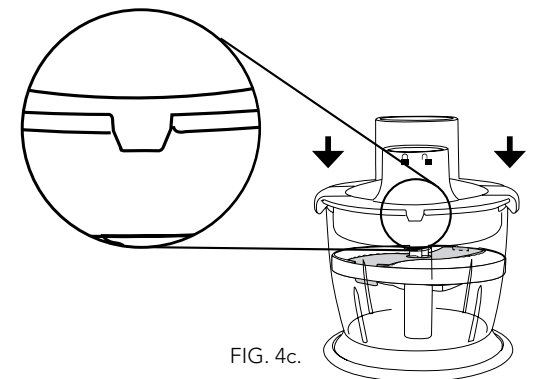

FIG. 4c.

5. To assemble the motor appliance, align the arrow mark on the motor appliance with the unlocked symbol (🔓) on the food processor lid and attach the motor body to the food processor lid. Turn the motor body in the clockwise direction until the arrow mark on the motor appliance is aligned with the locked symbol (🔒) on the lid and the motor appliance is securely locked in place as shown in Fig. 5a.

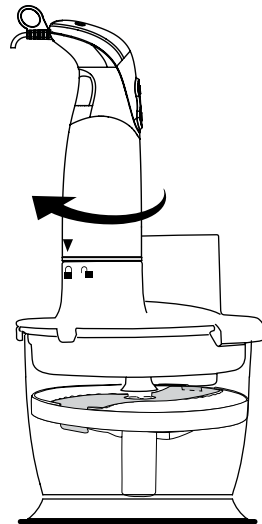
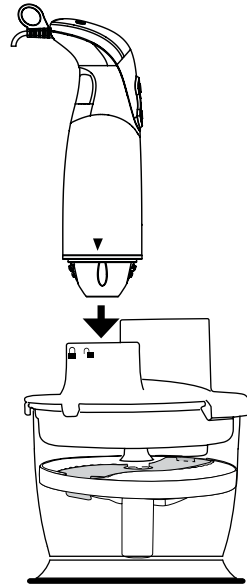

FIG. 5a.

HOW TO OPERATE THE FOOD PROCESSOR WITH DISC BLADE

1. Make sure that the non-slip base is correctly attached to the bottom of the food processor bowl.
2. Place the food processor on a flat surface such as a kitchen countertop.
3. Make sure that the lid is securely locked and the large food pusher and the small food pusher are in place, refer to Fig. 3a.
4. Plug the THUNDERSTICK™ into a power outlet.
5. Select which size feed tube/food pusher you want to use.

When processing small pieces of food insert the large food pusher (with built in small feed tube) into the feed tube on the food bowl lid and then use the small food pusher for pushing the food as illustrated in Fig. 5a.

When processing large pieces of food use the large food pusher as illustrated in Fig. 5b.

Make sure that the small food pusher is inserted into the small feed tube in the large food pusher.

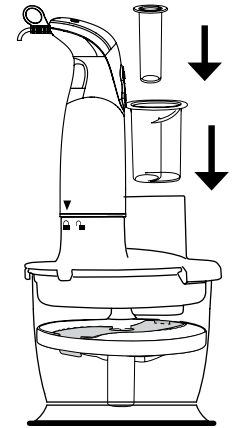

FIG. 3a.

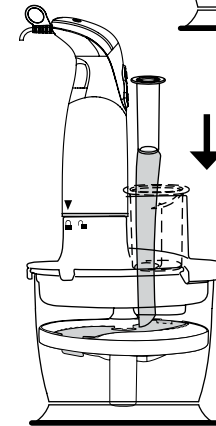

FIG. 5a.

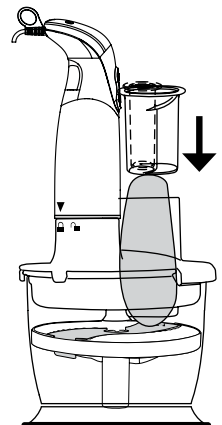

FIG. 5b.

THANE HOUSEWARES™

THUNDER STICK™



THANE HOUSEWARES™

Thane International, Inc.
La Quinta, CA 92253, U.S.A.
www.thane.com

Thane Direct Canada Inc.
Mississauga, ON L4W 5M6, Canada
www.thane.ca

Thane Direct UK Ltd.
Admail ADM3996, London W1T 1ZU, U.K.
www.thanedirect.co.uk

MADE IN CHINA

THANE HOUSEWARES™ is a registered trademark of Thane International, Inc.
© 2011 THANE INTERNATIONAL, INC.

Thunderstick-220V MNL ENG R2 110928